

NODE DOWNLIGHT USER MANUAL

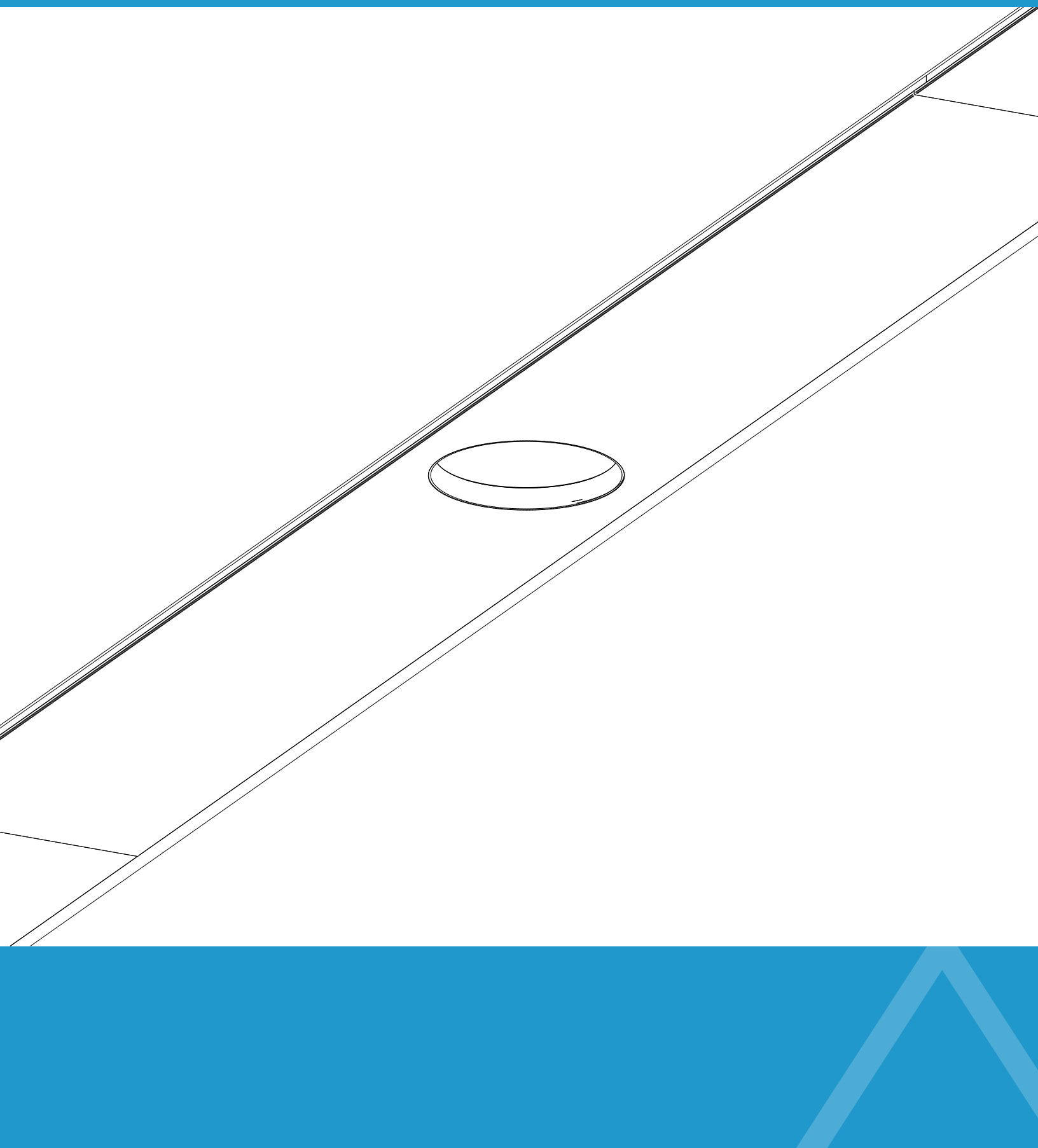

1 Safety Information

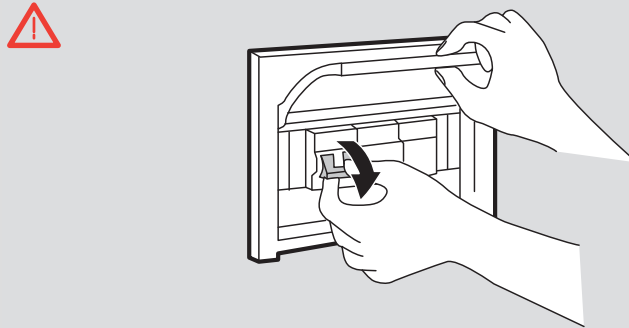
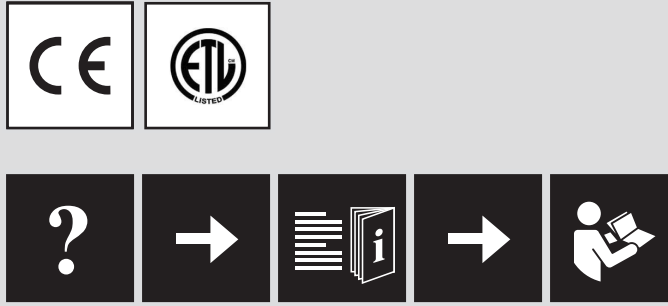

2 Required Parts

A) Recessed Channel

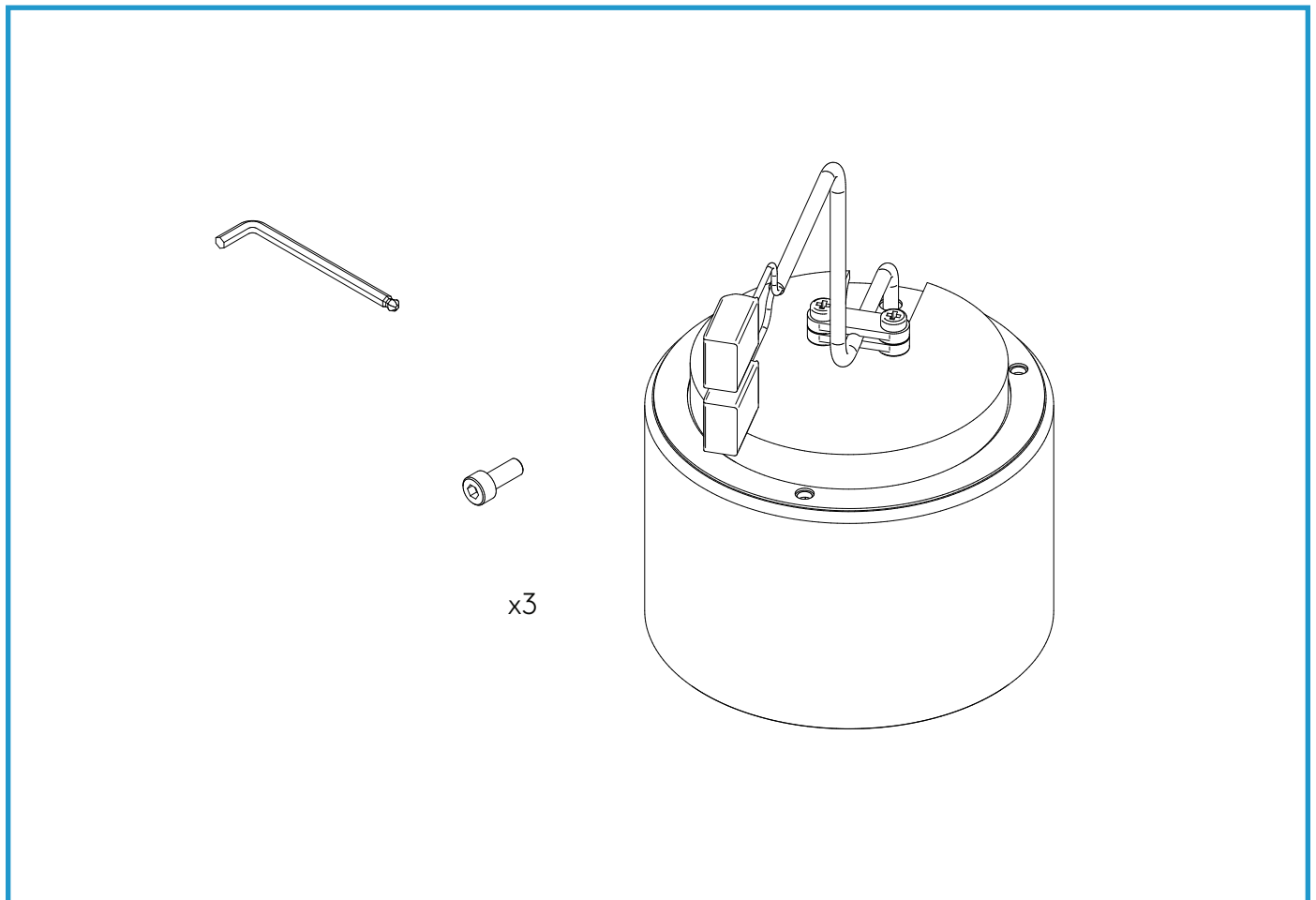

B) Trimless

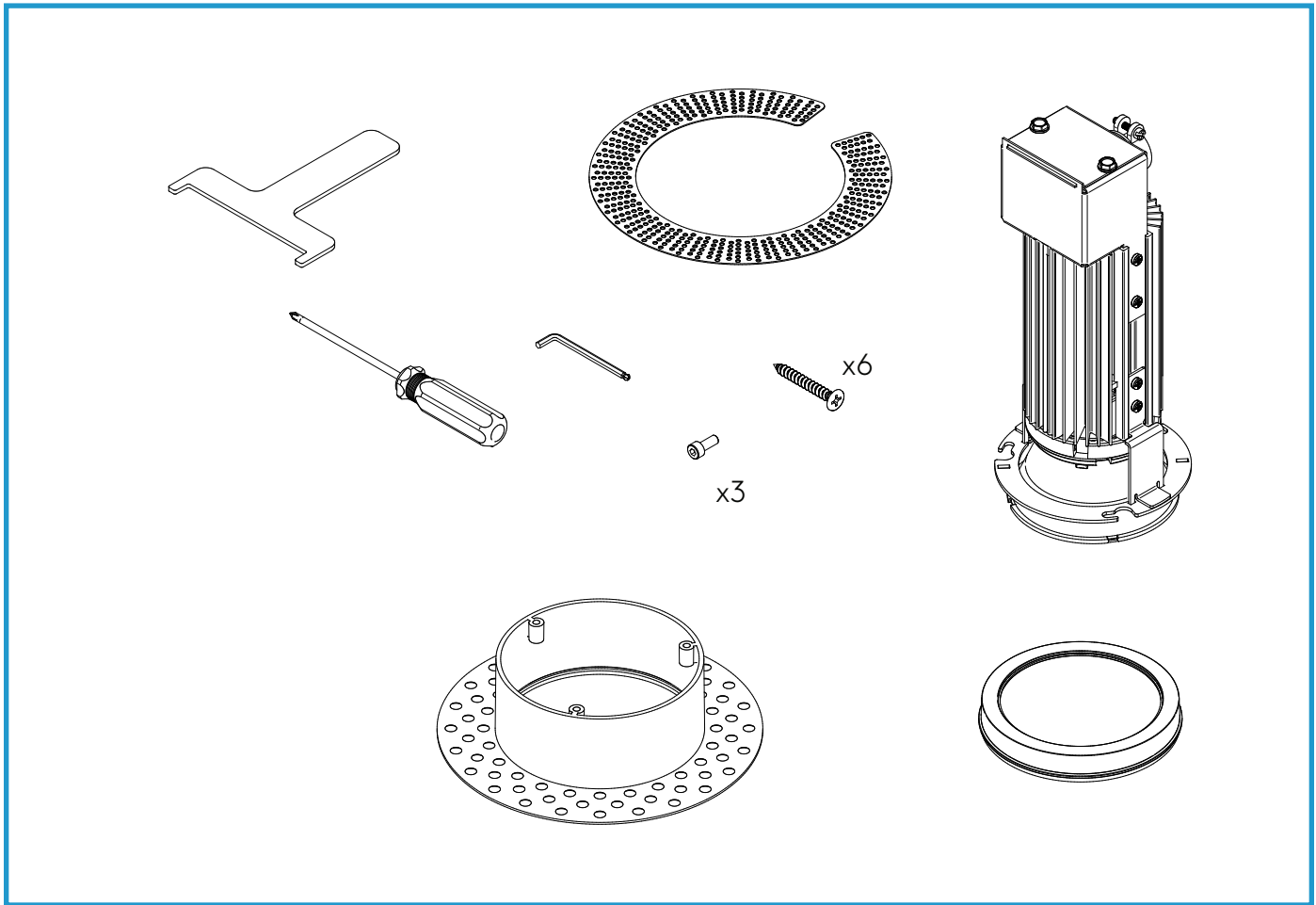

C) Flush Channel

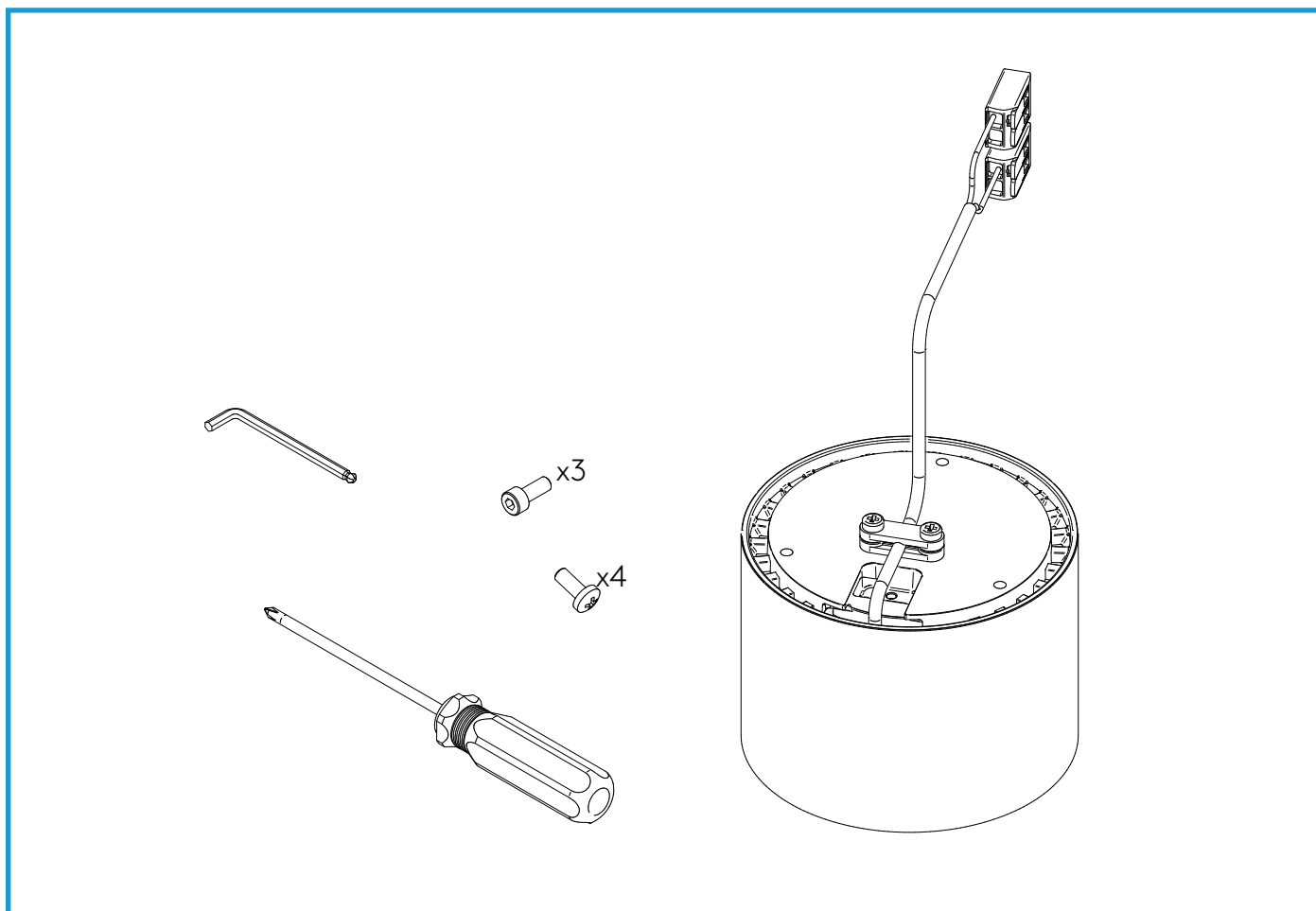

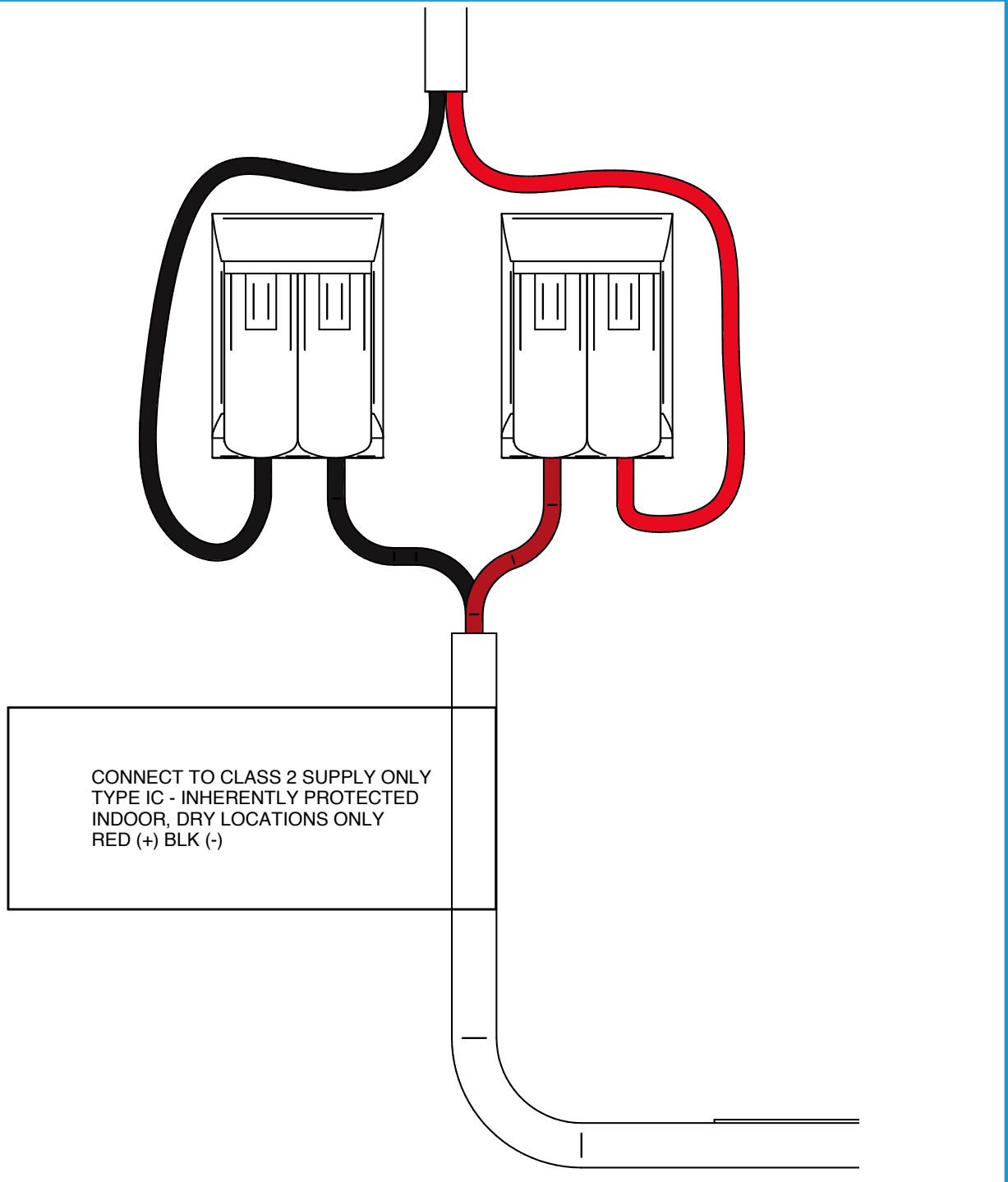

NOTE: Installation must be completed by a qualified electrician in accordance to local building codes. For locations where the National Electrical Code (NEC) is enforced, refer to article 411.5A for wiring in a ceiling, article 411.6 for wiring secondary units, and article 411.7 for wiring branch circuits.

4

Mounting Scenarios

A) Recessed Channel Installation

1 of 4

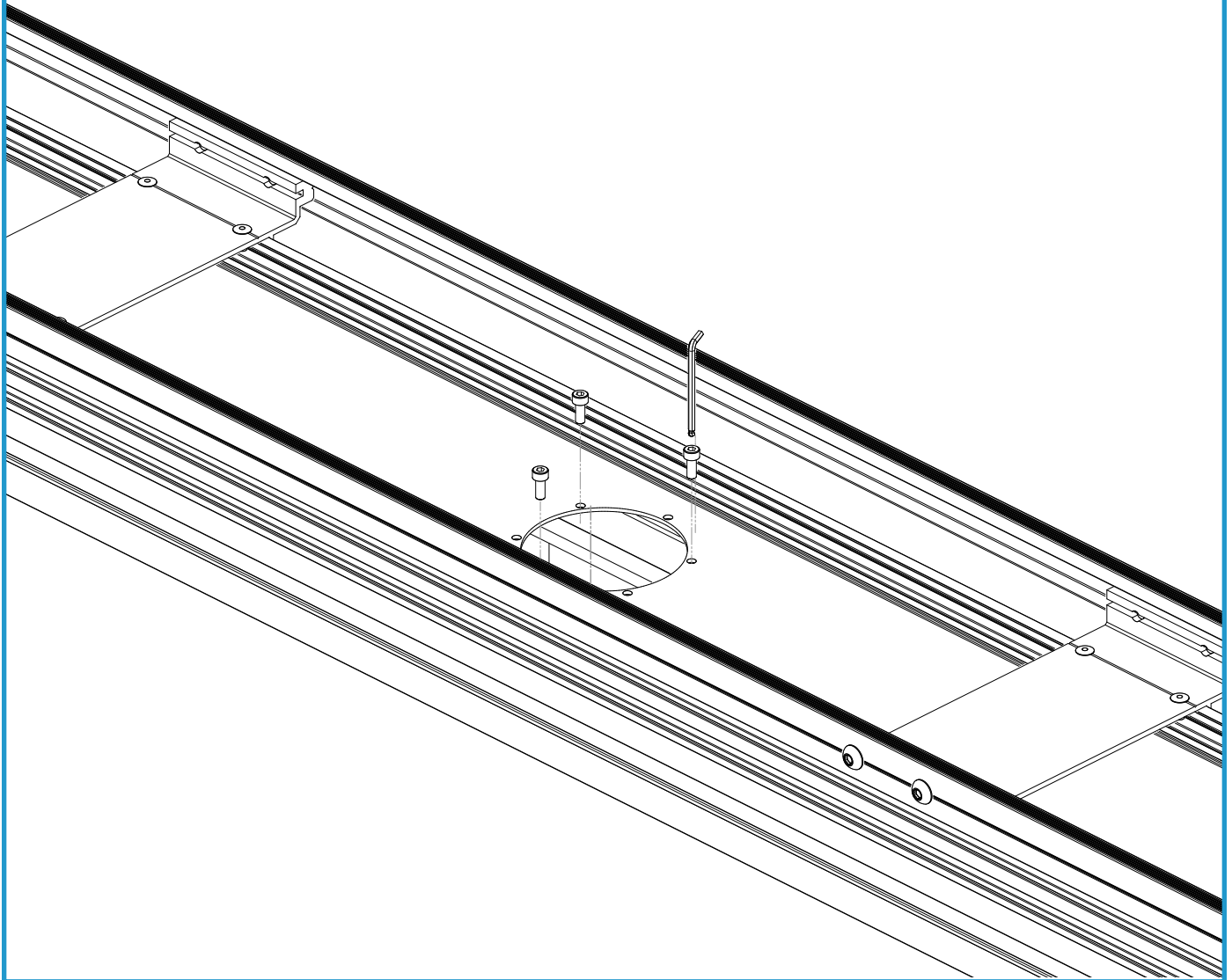

2 of 4

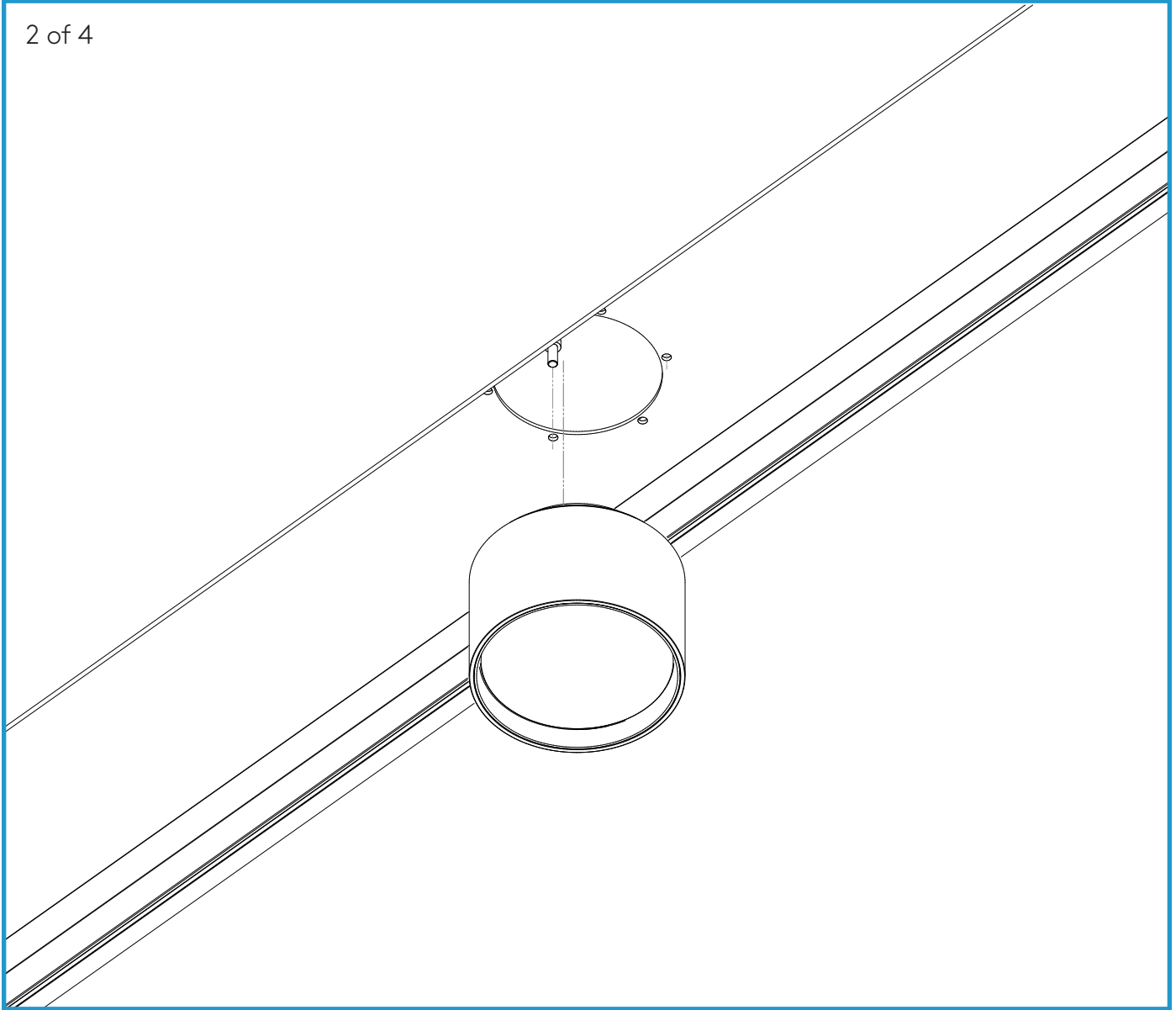

3 of 4

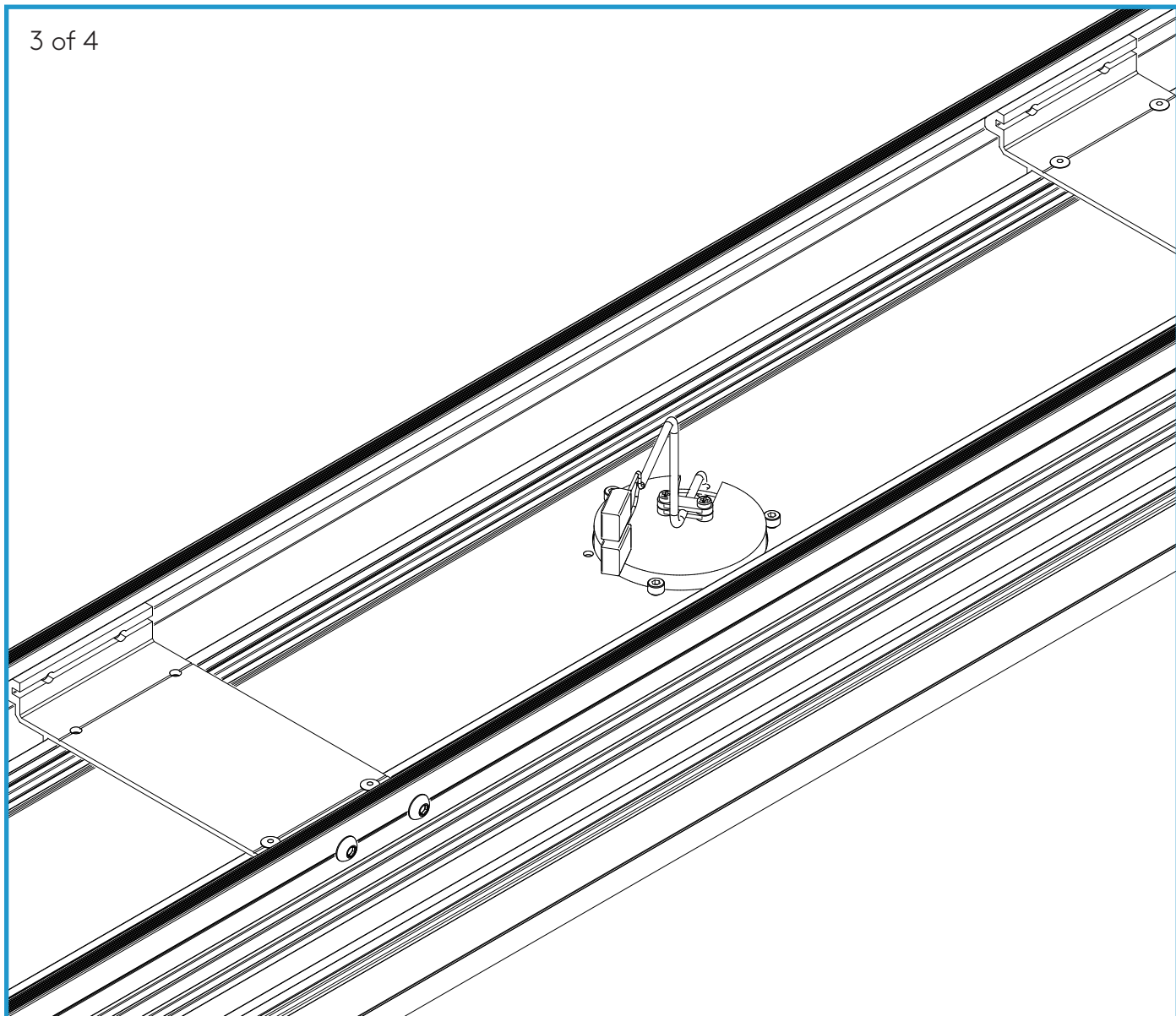

4 of 4

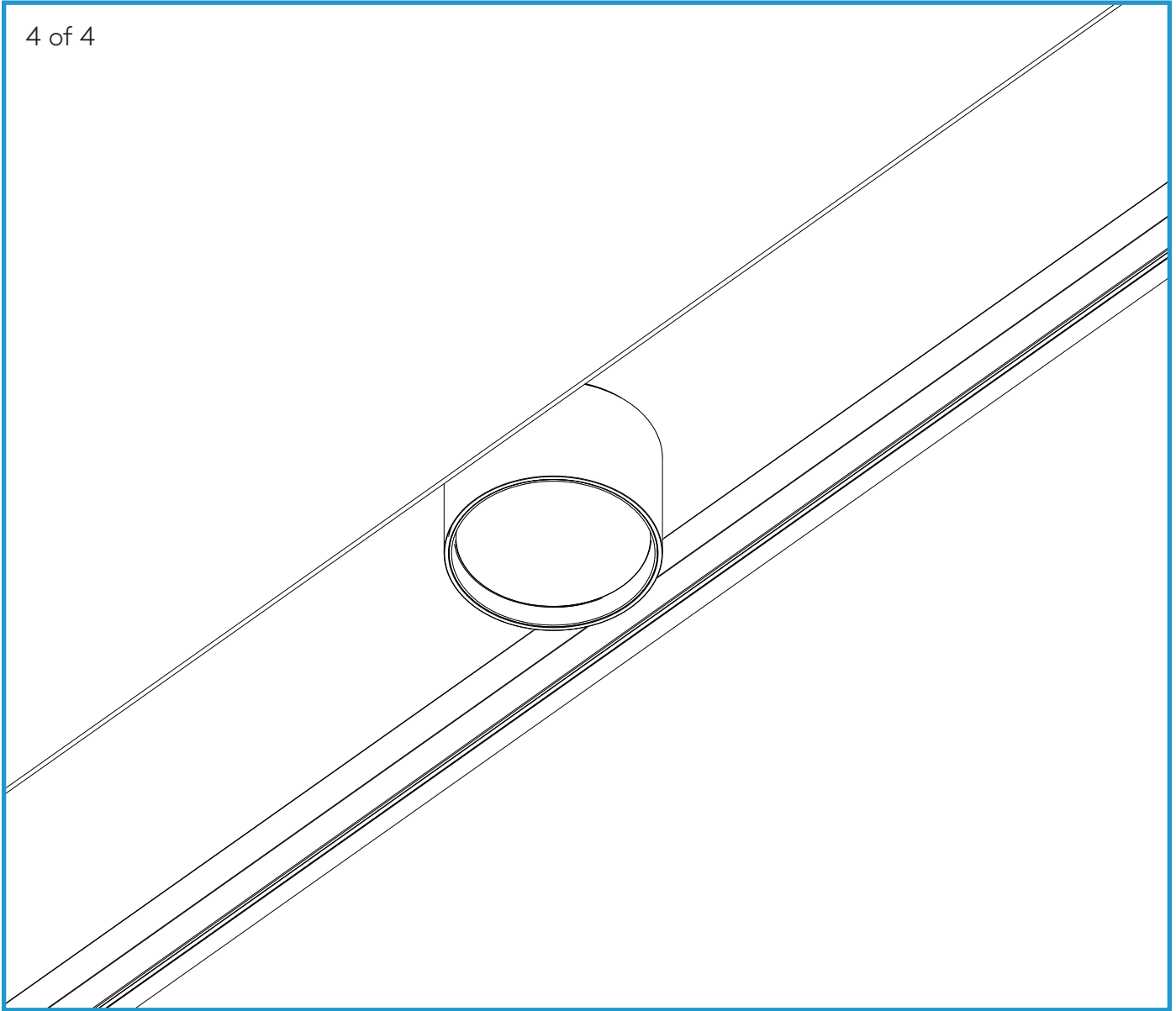

4 Mounting Scenarios

B) Trimless Installation

1 of 14

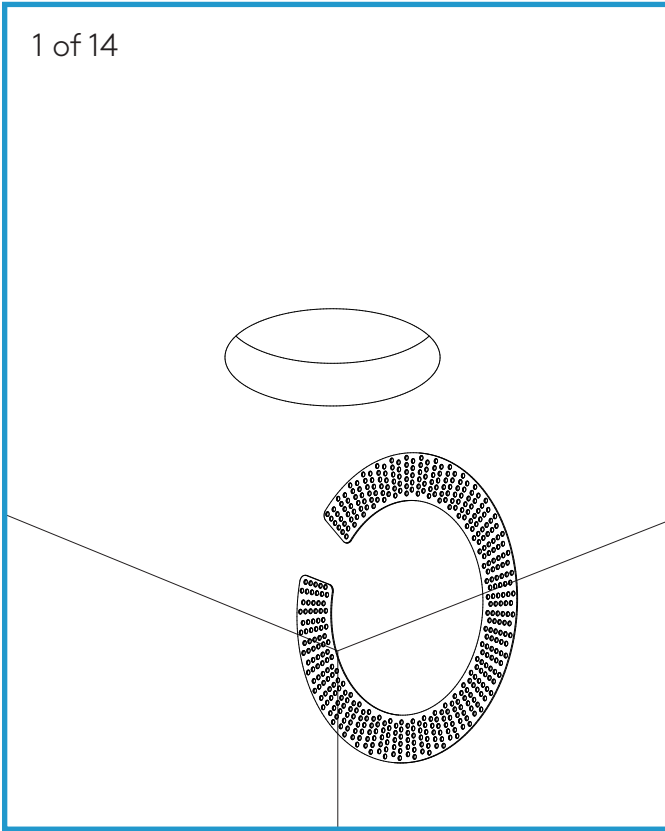

2 of 14

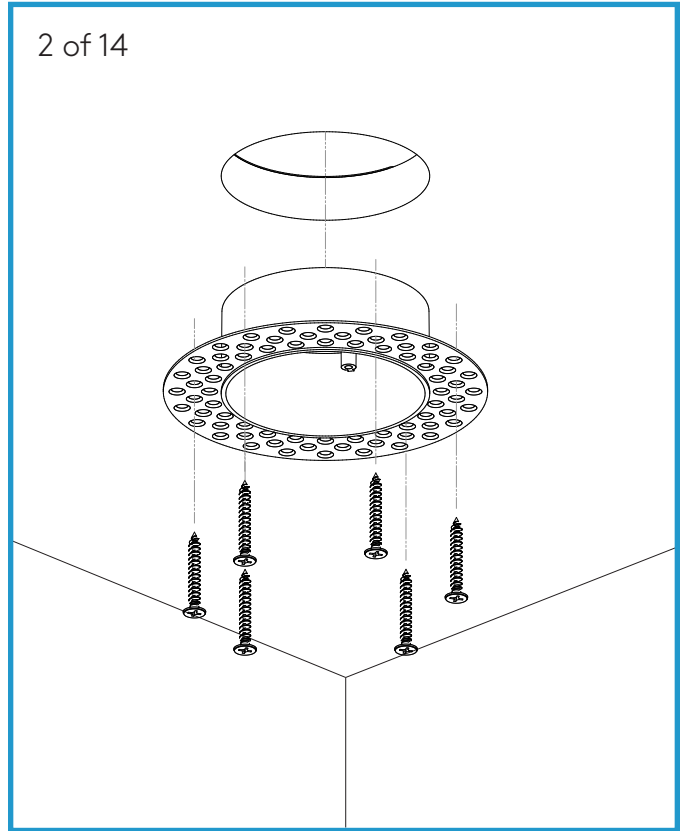

3 of 14

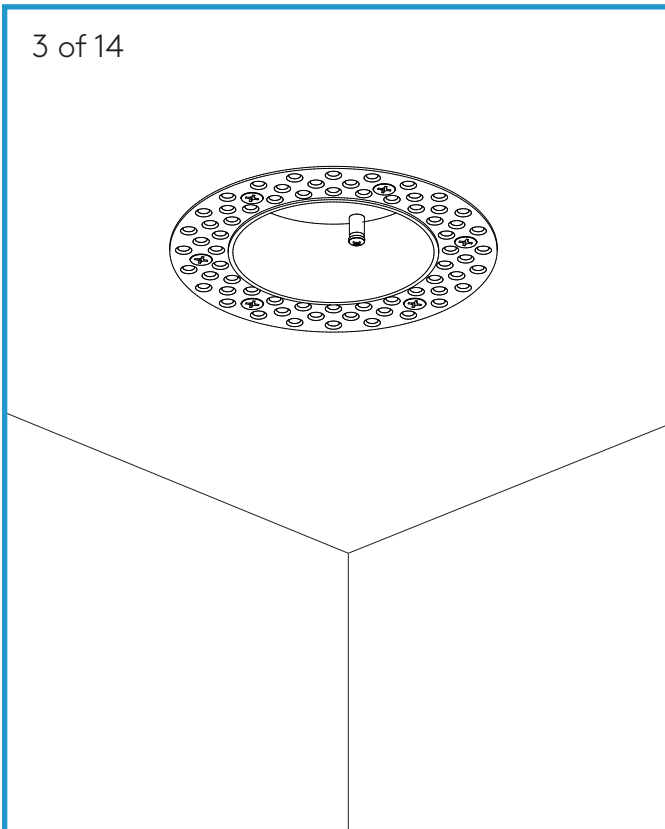

4 of 14

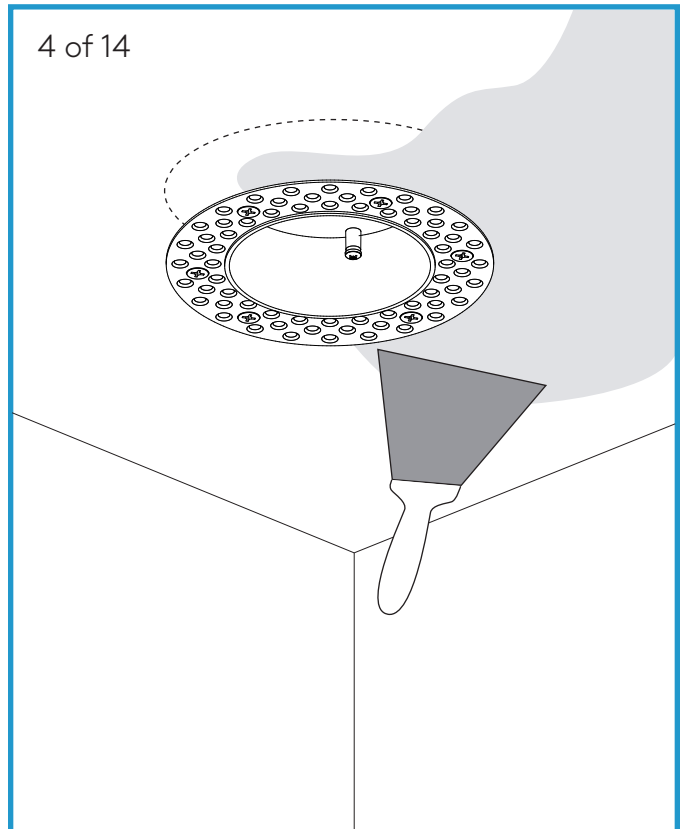

5 of 14

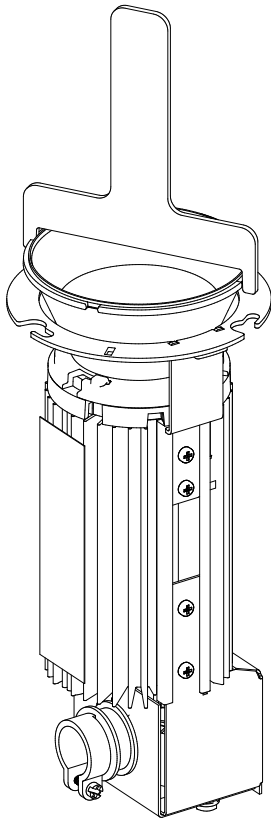

6 of 14

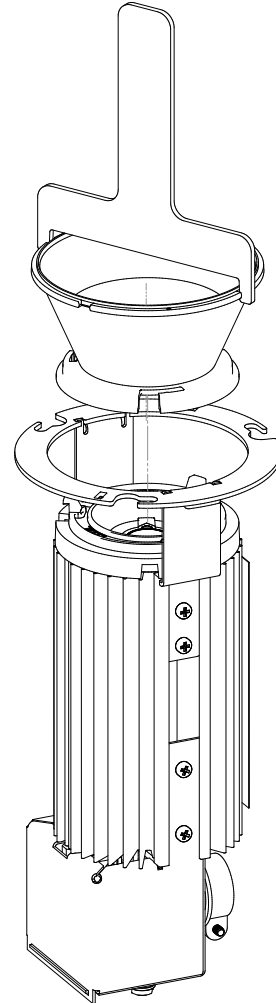

7 of 14

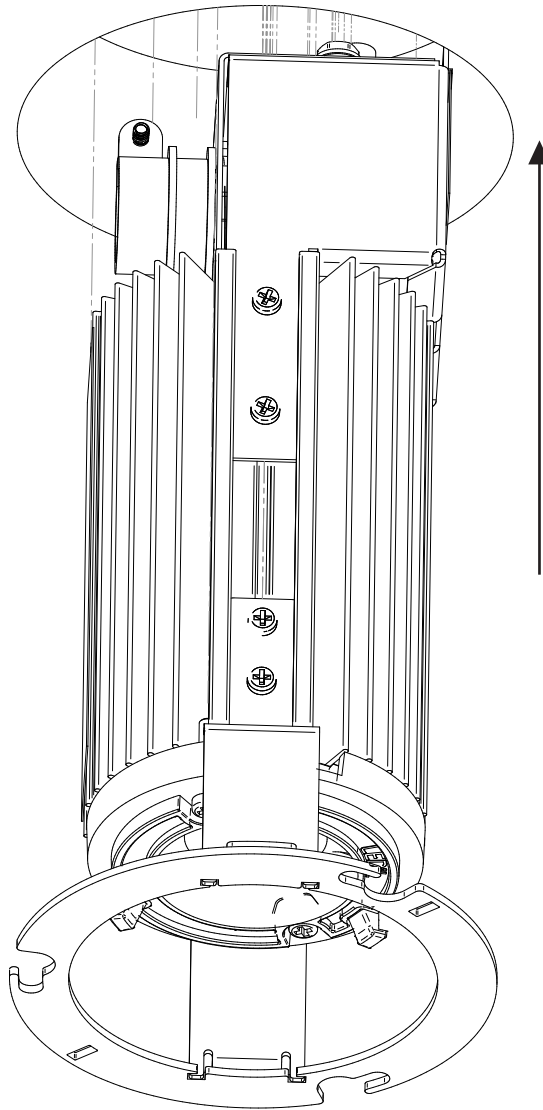

8 of 14

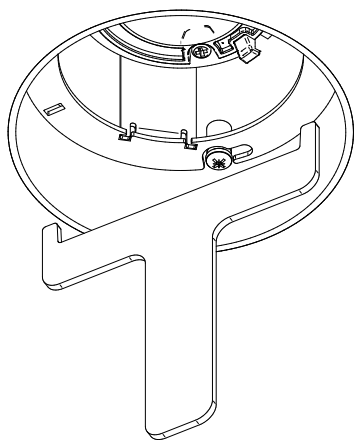

9 of 14

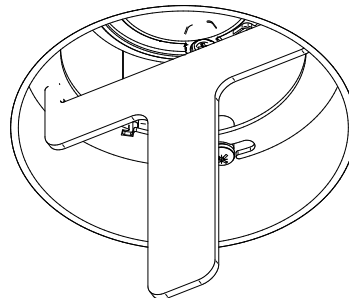

10 of 14

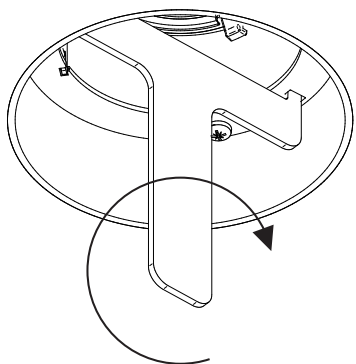

11 of 14

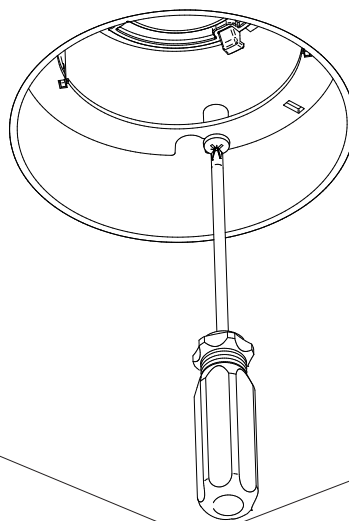

12 of 14

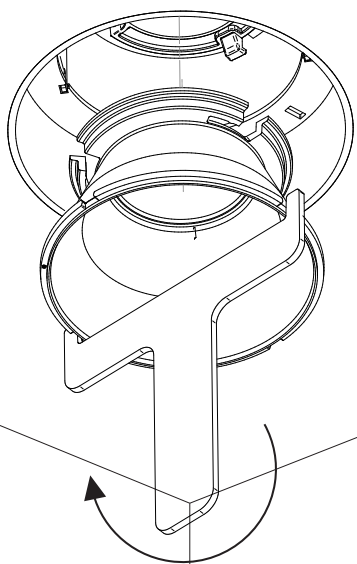

13 of 14

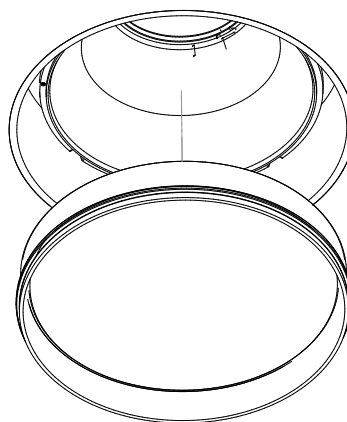

14 of 14

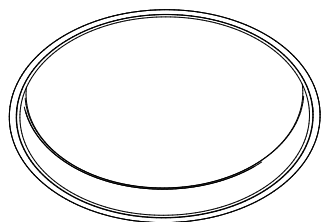

4

Mounting Scenarios

C) Flush Channel Installation

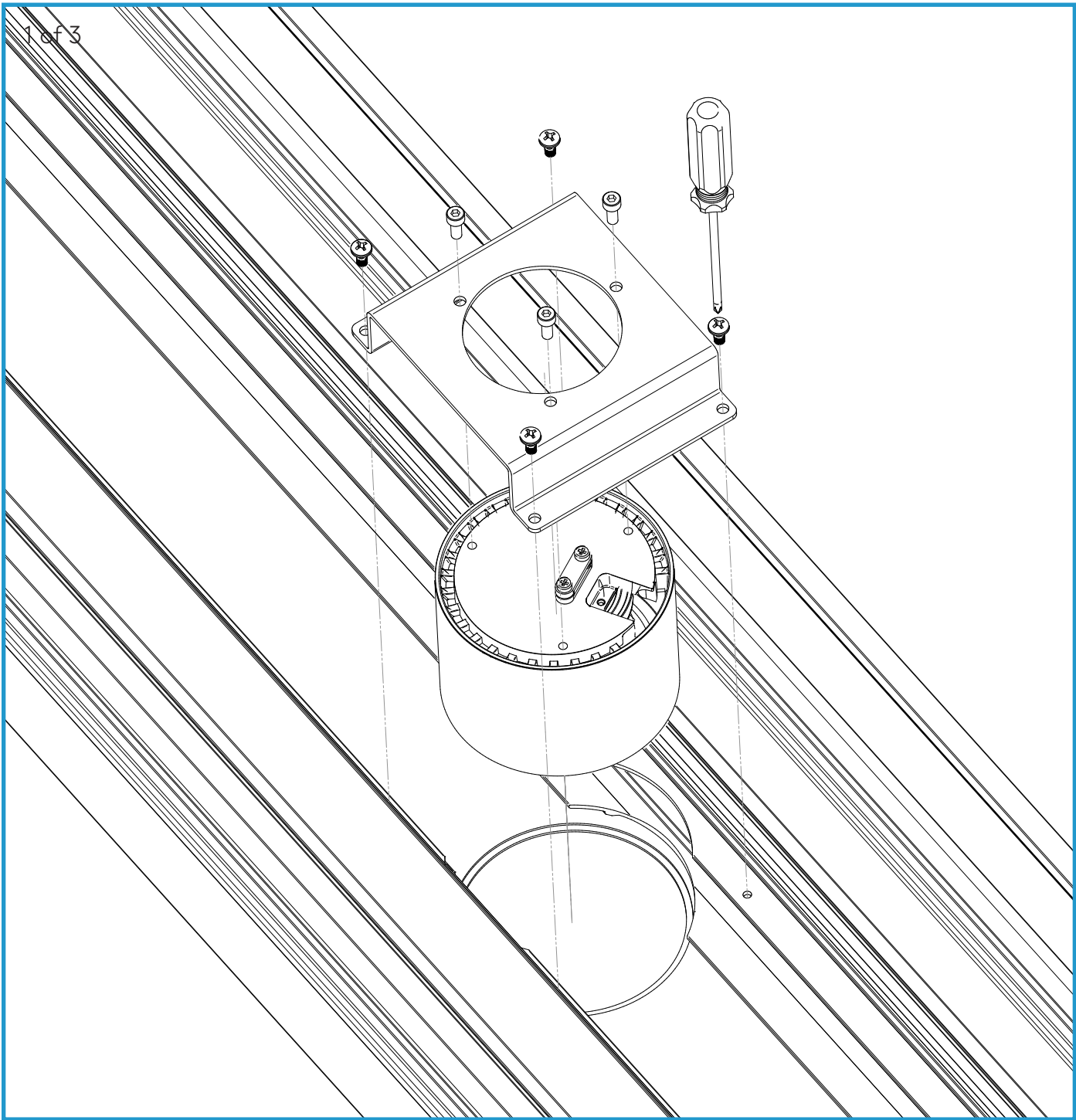

2 of 3

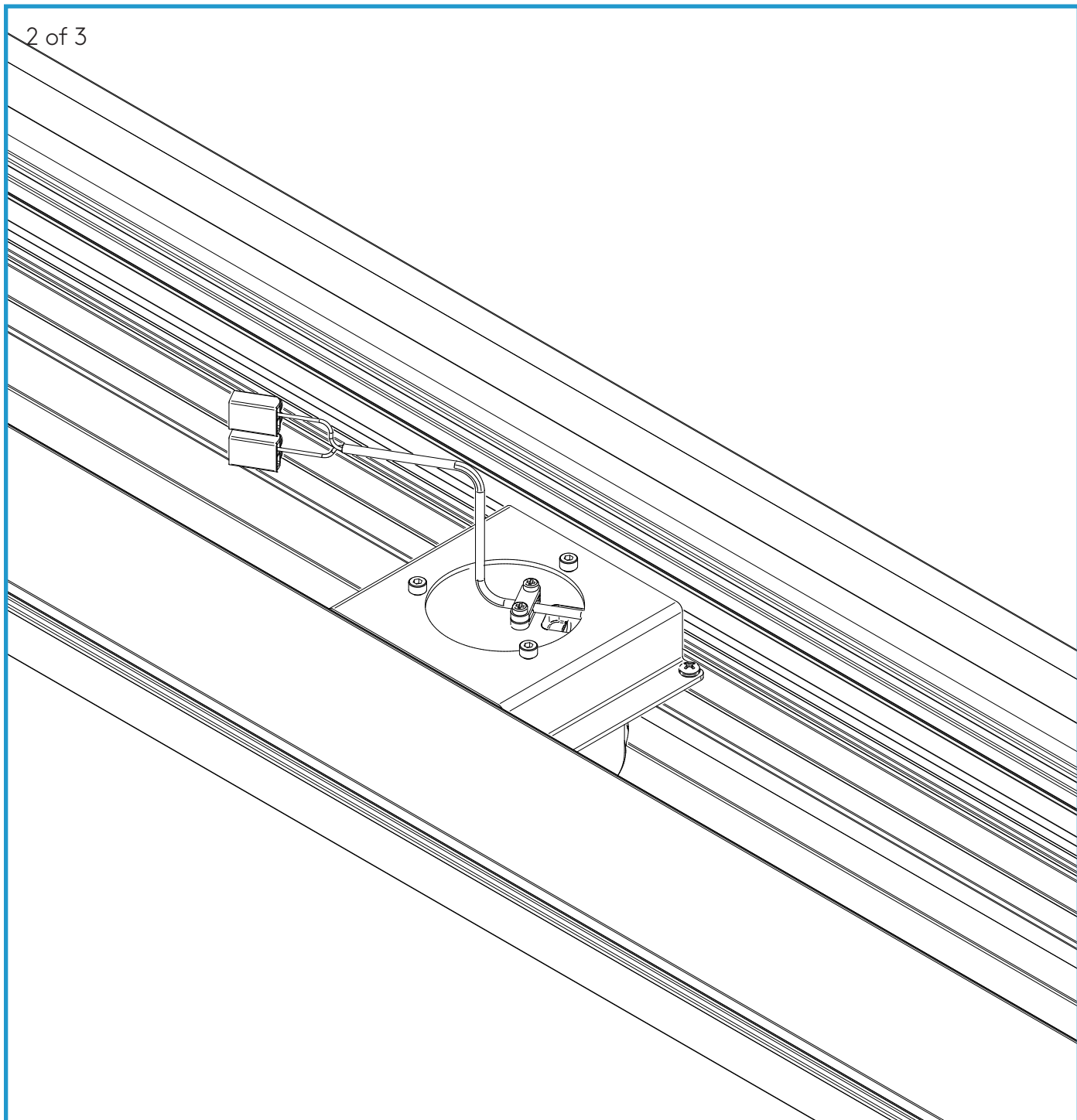

3 of 3

